

Santa Fe Plaza - #200, 18216 102 Avenue NW
Edmonton, Alberta



PROPERTY HIGHLIGHTS

- Located in the Santa Fe Plaza in Northwest Edmonton
- Well-maintained and nicely landscaped plaza
- Second floor office space
- Great access to 184 Street, Stony Plain Road and the Anthony Henday
- Elevator

Site Tour Information

Site tours by appointment only

Miguel Martinez | Special Projects Manager

780.421.4000 | miguel@yorkrealty.ca | [YORKREALTY.CA](https://www.yorkrealty.ca)

Canadian Western Bank Place

Suite 1622, 10303 Jasper Avenue
Edmonton, Alberta | T5J 3N6

Santa Fe Plaza - #200, 18216 102 Avenue NW

Edmonton, Alberta



DETAILS

Building	Santa Fe
Year Built	1990
Product	Second floor office
Address	#200, 18216 - 102 Ave NW
Total Vacant	7,745 SF (Option to demise)
Minimum Contiguous	2,710 SF
Zoning	DC
Heating	HVAC
Lighting	T12H0
Fiber	Yes
Sprinklers	Yes
Parking	Dedicated stalls in front of space; scramble parking throughout the complex

LEASE INFORMATION

Operating Costs	\$6.88 PSF (est. 2019)
Lease Rate	Market
Available	Monday, April 01, 2019

Site Tour Information

Site tours by appointment only

Miguel Martinez | Special Projects Manager
780.421.4000 | miguel@yorkrealty.ca | YORKREALTY.CA

Canadian Western Bank Place
Suite 1622, 10303 Jasper Avenue
Edmonton, Alberta | T5J 3N6

Santa Fe Plaza - #200, 18216 102 Avenue NW
Edmonton, Alberta

FLOOR PLAN

TOTAL VACANT
7,745 SF (Option to Demise)

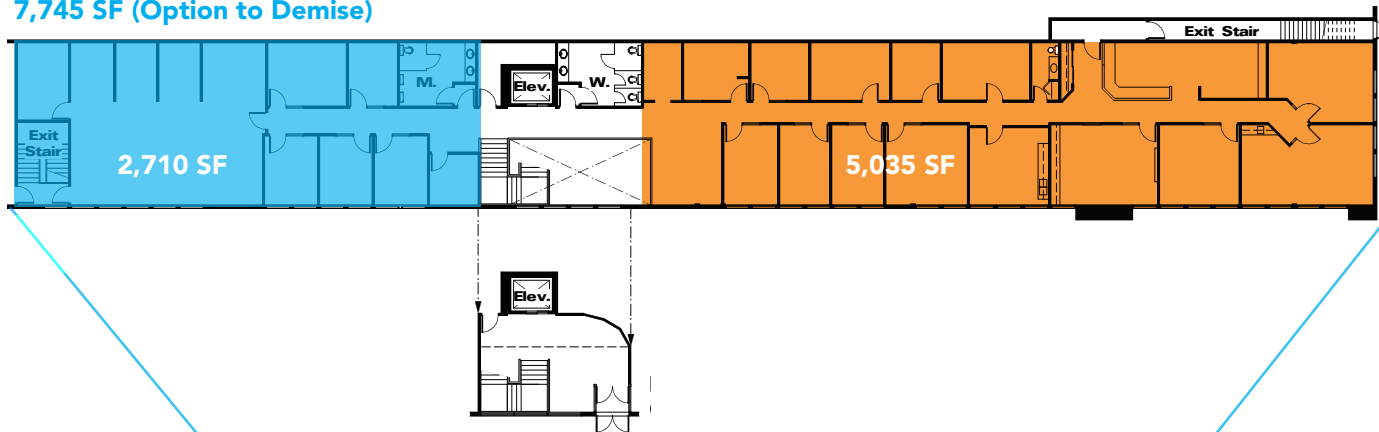

Santa Fe Plaza - #200, 18216 102 Avenue NW

Edmonton, Alberta



Site Tour Information

Site tours by appointment only

Miguel Martinez | Special Projects Manager

780.421.4000 | miguel@yorkrealty.ca | YORKREALTY.CA

Canadian Western Bank Place

Suite 1622, 10303 Jasper Avenue
Edmonton, Alberta | T5J 3N6