

MEZZANINES
FREE OF CHARGE
FREE RENT



PROPERTY HIGHLIGHTS

- Located in the Santa Fe Plaza in Northwest Edmonton
- Well-maintained and nicely landscaped plaza
- Office & warehouse spaces
- Grade loading
- Great access to 184 Street, Stony Plain Road and the Anthony Henday

Site Tour Information Site tours by appointment only

Miguel Martinez | Special Projects Manager

780.421.4000 | miguel@yorkrealty.ca | YORKREALTY.CA

Canadian Western Bank Place

Suite 1622, 10303 Jasper Avenue

Edmonton, Alberta | T5J 3N6

Santa Fe Bldg. - 18166 & 18112 102 Ave NW

Edmonton, Alberta

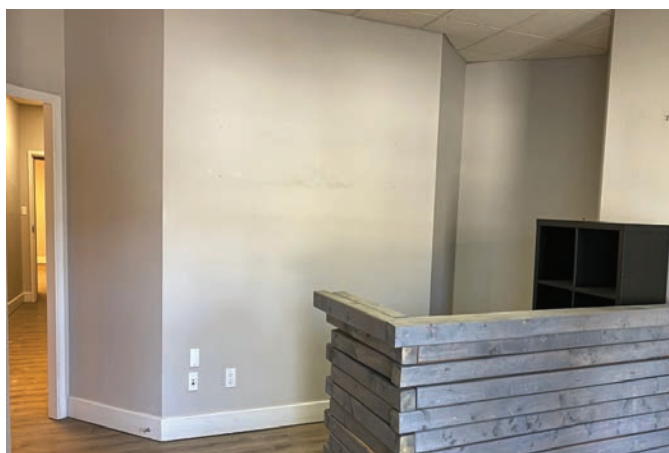

DETAILS	
Address	18166 & 18112 102 Ave NW
Zoning	DC-Development Control
Year Built	1990
Power	100 Amps 120/208 Volts To be confirmed by the tenant
Available Area	Unit 18166 -2,550 SF +616 Mezz free of charge Unit 18112 - 5,231 SF +3,201 Mezz free of charge
Loading	Unit 18166 - One grade door (10x14) Unit 18112 - One grade door (10x14)
Construction	Centre block / steel frame
Sprinklers	No
Fibre Optics	Available
Drain	Available
Ceiling Height	20' Feet
Heating	Unit Heater & HVAC Office
Lighting	T8H0 & T12H0 - Option to upgrade to LED

LEASE INFORMATION	
Operating Costs	Market
Base Rent	Market
Available	Immediately

Site Tour Information Site tours by appointment only

Miguel Martinez | Special Projects Manager
780.421.4000 | miguel@yorkrealty.ca | YORKREALTY.CA

Canadian Western Bank Place
Suite 1622, 10303 Jasper Avenue
Edmonton, Alberta | T5J 3N6

FLOOR PLAN - 18166

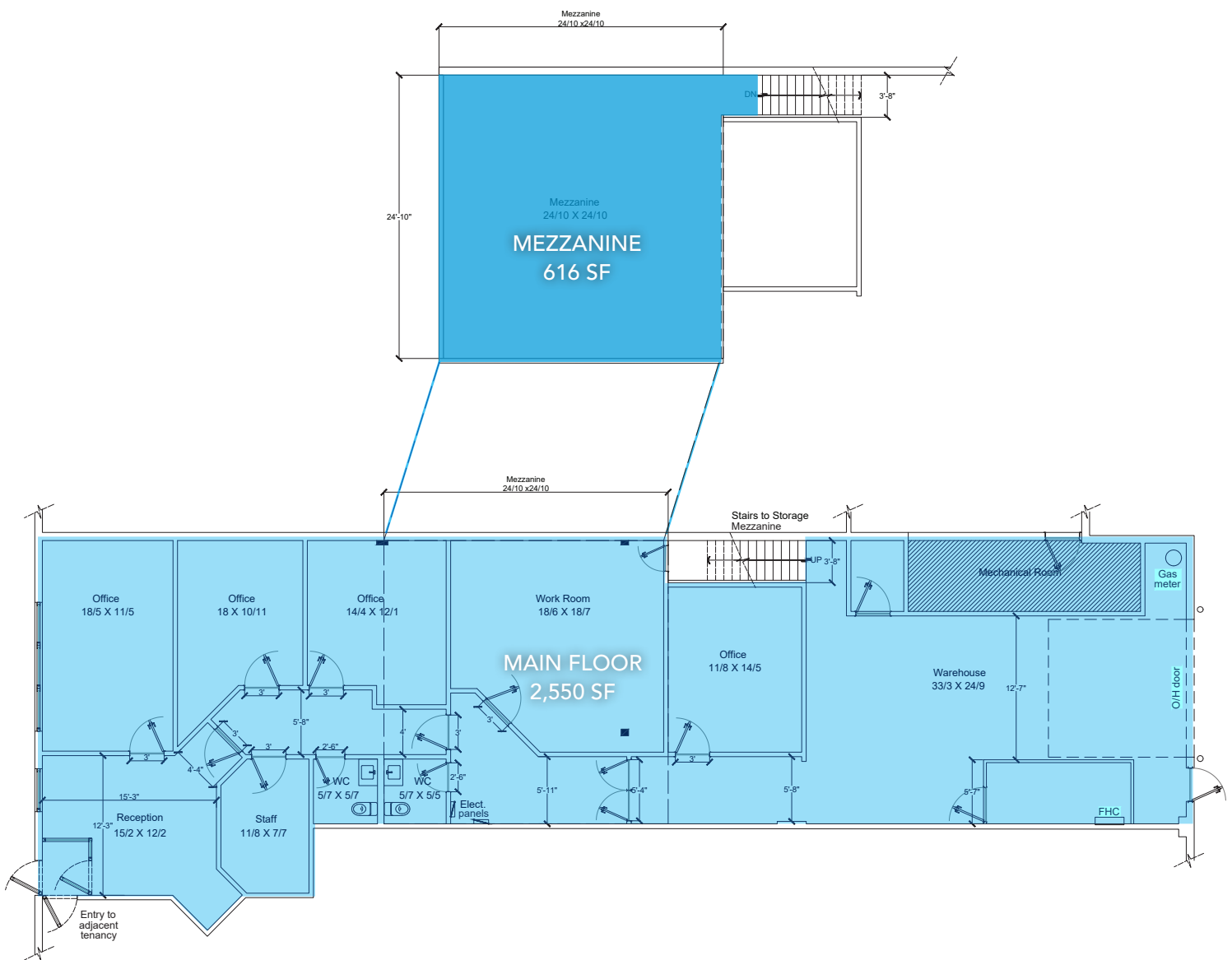

FLOOR PLAN - 18112

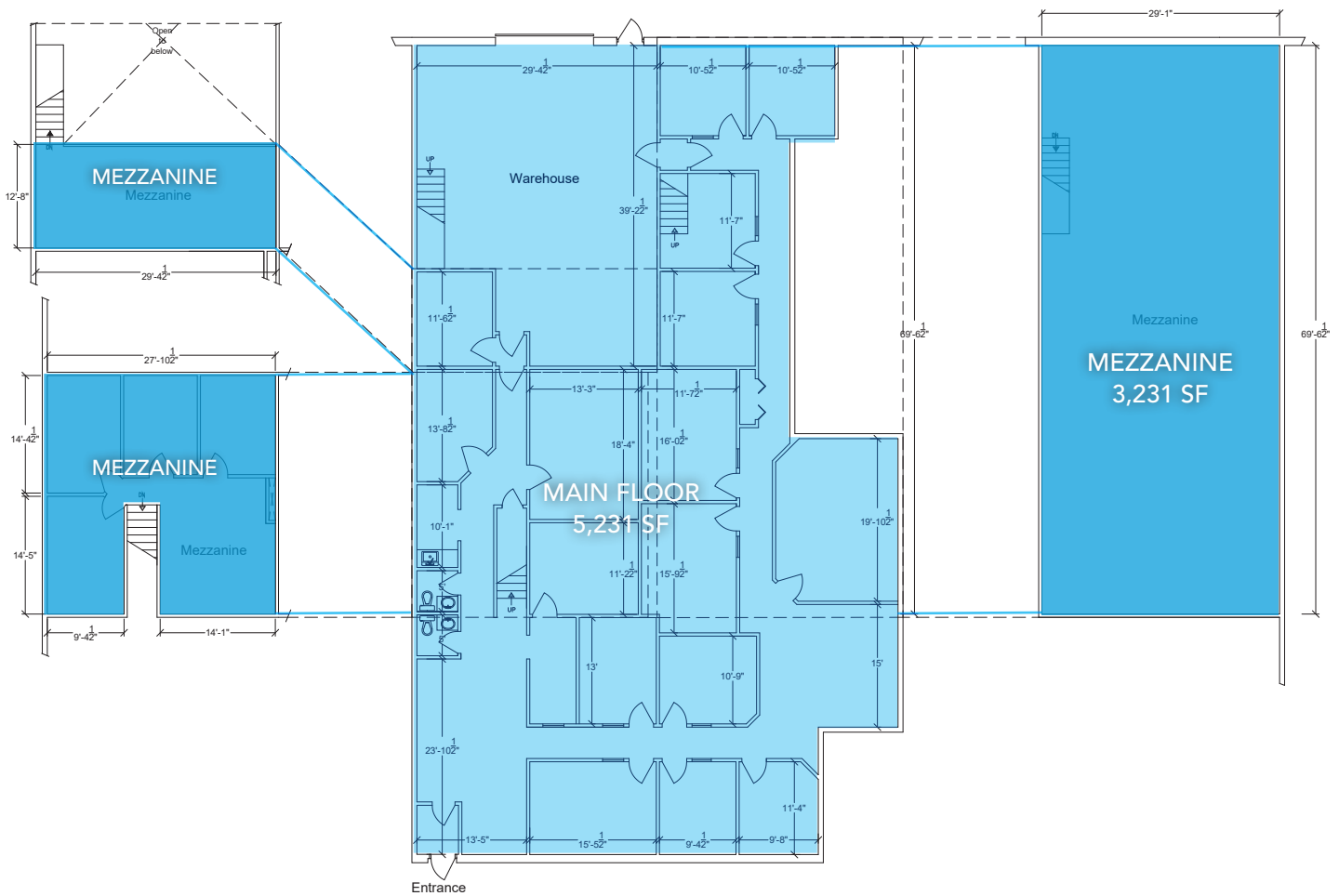

Available For Lease



INDUSTRIAL OFFICE & WAREHOUSE OPPORTUNITY

Santa Fe Bldg. - 18166 & 18112 102 Ave NW

Edmonton, Alberta

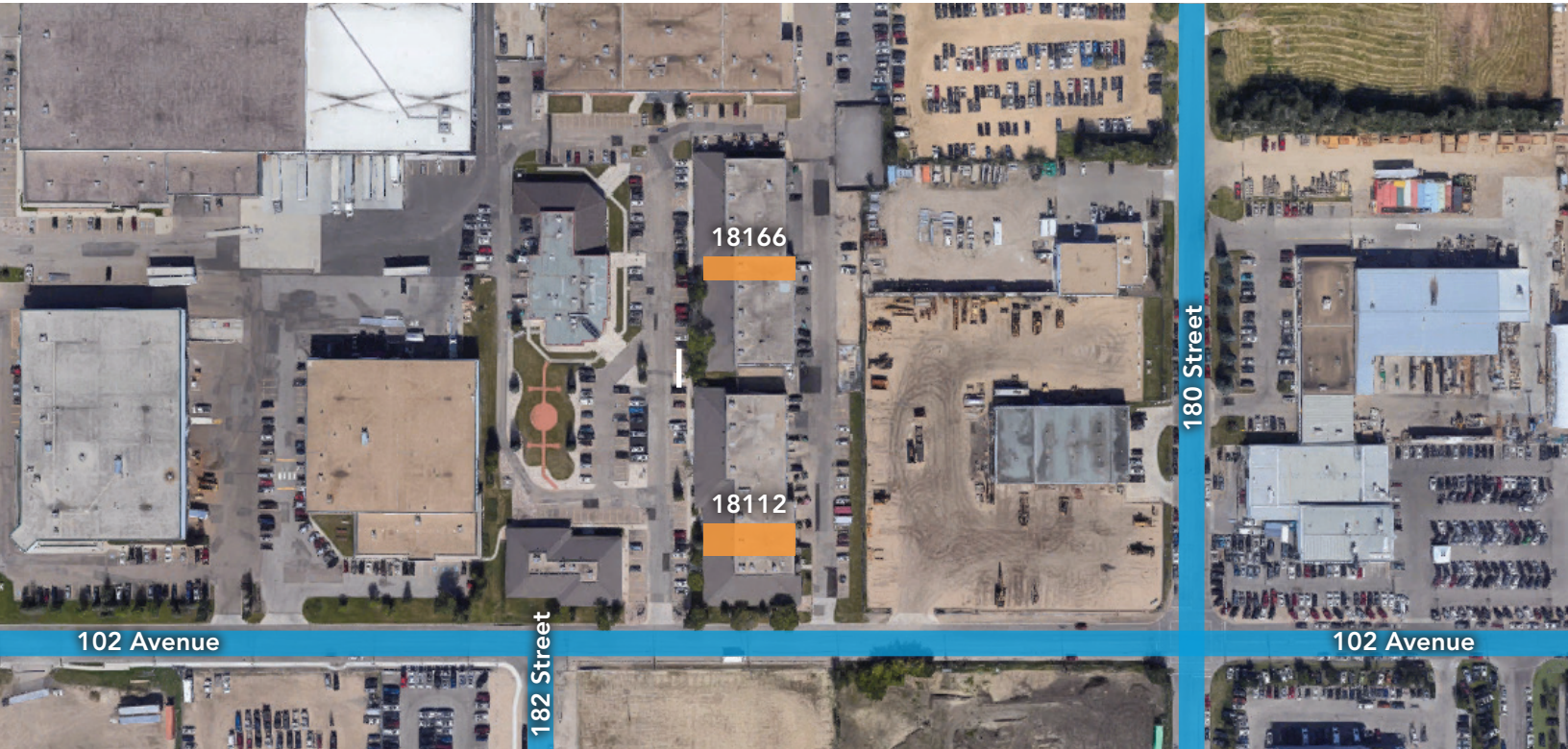

Site Tour Information

Site tours by appointment only

Miguel Martinez | Special Projects Manager

780.421.4000 | miguel@yorkrealty.ca | YORKREALTY.CA

Canadian Western Bank Place

Suite 1622, 10303 Jasper Avenue
Edmonton, Alberta | T5J 3N6